



PROJECT BRIEF



Houston Project:
OUTDOOR KITCHEN

JULY, 2014



The WaterStone Group, Inc.

A Texas-Based Creative Consortium

Houston, Texas

thomasmciesla@gmail.com



CONTENTS

- Goals & Vision
- Concept Development
- Existing Layout
- Revised Layout
- Details



REQUIREMENTS

Notes

1. No part of this yard receives more than five hours of continuous sunlight.
2. Landscape design is not within the scope of this project.

Site is located in a subdivision in northern Harris County, 25 miles from downtown Houston, Texas. The rear yard is an average-size subdivision parcel dominated by a large concrete patio, perimeter plantings, and several 30-foot tall pine trees. These trees constantly drop debris over the entire yard for most of the year.

The goal of this study is to incorporate a minimalistic outdoor kitchen on one side of the existing patio. Kitchen shall have no running water, refrigerators, or other type of appliances. A gas grill, and a separate griddle cooker should be incorporated. Large cabinet/bar top is also required.

The client has requested a pergola over the area, with enough structure to provide shade. For ease of maintenance the pergola should not catch the tree debris. Kitchen area shall have a paver floor.

The existing lawn sits two inches higher than the patio creating a serious drainage problem. This must be aesthetically addressed in the design solution.



CONCEPT DEVELOPMENT

The initial concept placed the kitchen area at an angle to the existing patio with a fire pit on the east end. Further analysis moved the fire pit in-line with the long axis of the kitchen while allowing for a rock trench to drain the existing patio. For continuity, the floor of the kitchen was extended to cover the short walkway and small patio slab on the Master Bedroom side of the house.

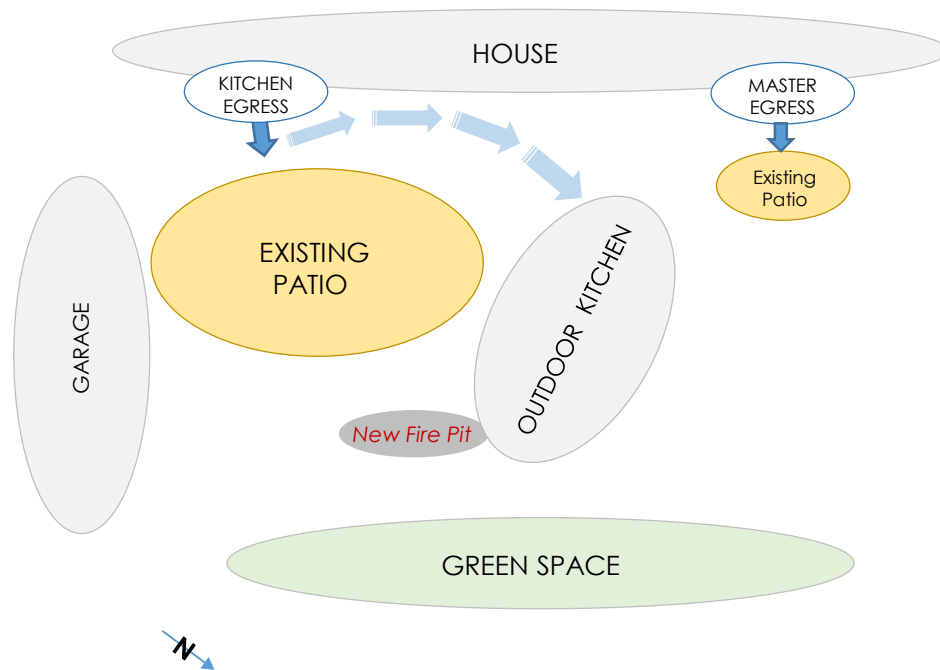

Initial Concept

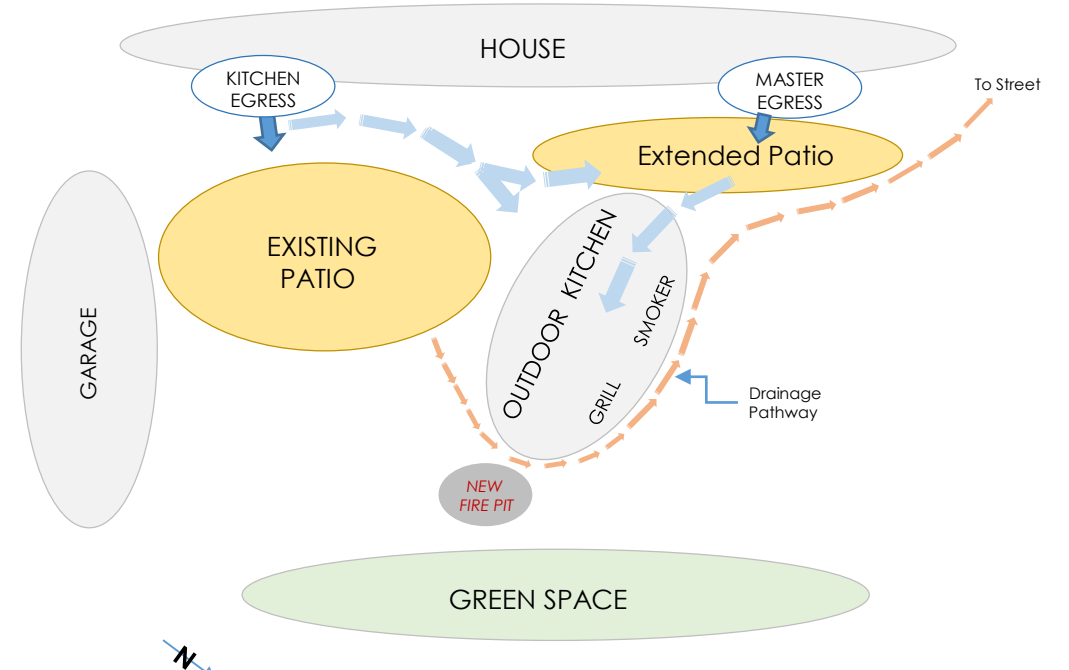

Revised Concept



EXISTING LAYOUT

PROJECT BRIEF

Notes

1. Patio is concrete
2. Raised lawn area inhibits patio drainage. Natural grade of lawn area slopes towards bedroom patio.
3. Yard contains eight large pine trees.

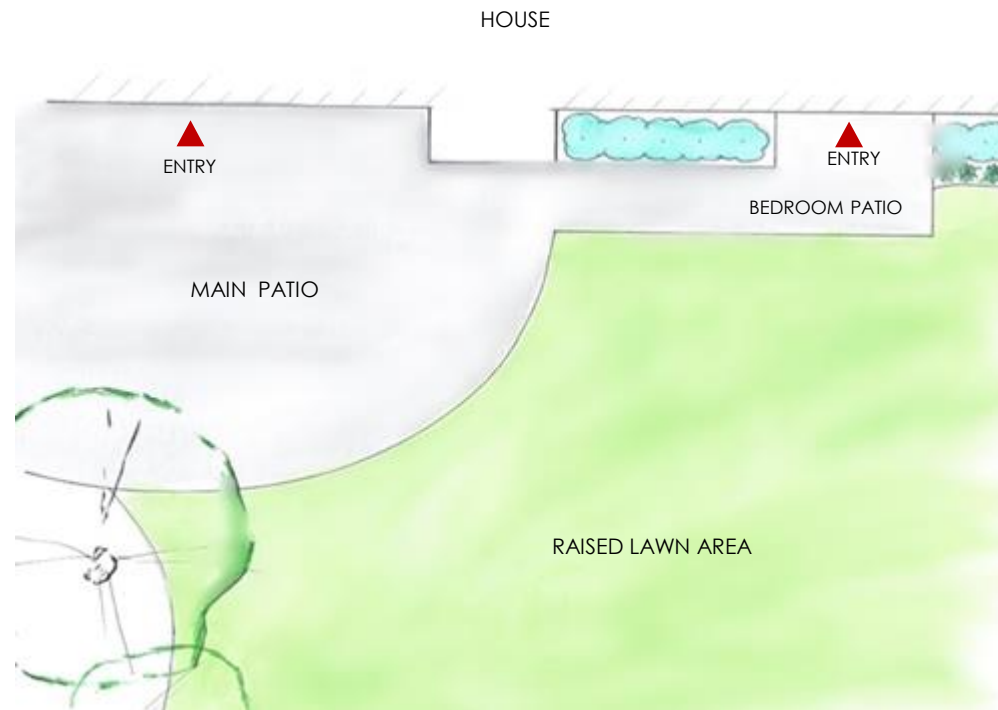



REVISED LAYOUT

PROJECT BRIEF

Notes

- 1. Main patio left as-is
- 2. Passive and active drainage systems incorporated

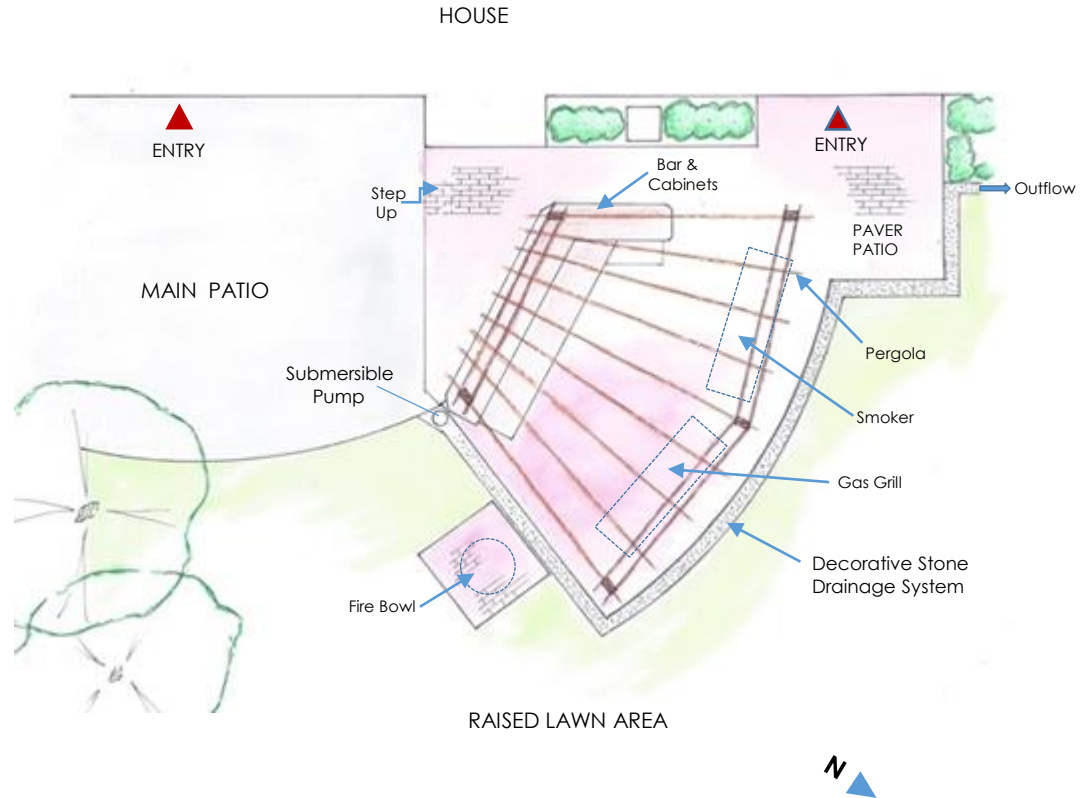



AS-BUILT

PROJECT BRIEF

